

Bayut.com

For all your property needs

B
a
y
u
t
.c
o
m



Table of Contents

Property Description	3
Contact Details	3
Property Features.....	4
Image Gallery	5
Floorplans.....	7
Development	8

Property Description:



2 Beds Apartments

Very nice huge 2 bedrooms apartment is available for sale in Burj Khalifa, Downtown Dubai.

Beautiful view of city.

Ready to move in from April.

Contact us for more information.

- **Type** Apartment
- **Status** sold
- **Bedrooms** 2
- **Bathrooms** 3
- **Price** 6,860,000 AED
- **Area** 1,716 Sq. Ft.
- **Location** UAE » Dubai » Downtown Dubai » Burj Khalifa (Burj Dubai)

Contact Details:

- **Name** Shaun
- **Phone** +971-4-2235333
- **Fax**
- **Cell**
- **Address**

Property Features:

Main Features

- 24 Hours Concierge
- Central Air-Con
- Central Heating
- Completion Year 2009
- Double Glazed Windows
- Electricity Backup
- Floors in Building 162
- Lobby in Building
- Other Main Features Exclusive corporate suite offices, residential suites, a cigar club, observation platform, restaurants, library, exclusive resident's lounge, 15,000 square feet for fitness.
- Parking Spaces
- Service Elevators
- Waste Disposal

Business and Communication

- ATM Facility
- Broadband Internet
- Business Center
- Intercom
- Satellite/Cable TV

Healthcare and Recreation Facilities

- Jacuzzi
- Sauna
- Steam Room
- Swimming Pool

Healthcare and Recreation Facilities in Building

- Gym or Health Club

Image Gallery:



Burj Khalifa (Burj Dubai) Exterior2



Burj Khalifa (Burj Dubai) Exterior



Burj Khalifa (Burj Dubai) Exterior3



Burj Khalifa (Burj Dubai) Exterior4



Burj Khalifa (Burj Dubai) Exterior5



Burj Khalifa (Burj Dubai) Exterior6

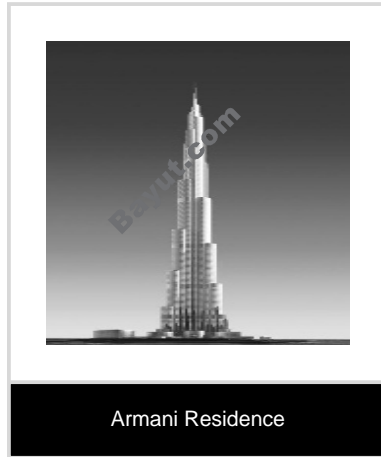

For larger view click link below

http://www.bayut.com/uae_dubai_apartments/burj_khalifa__burj_dubai__nice_2_b_r_apartment_for_sale-470163.html

► Floorplans:

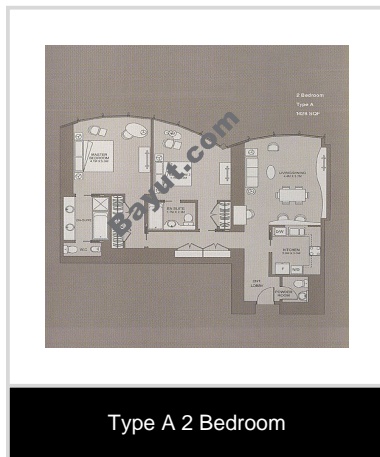

Type A 2 Bedroom



Type C 2 Bedroom

For larger view click link below

http://www.bayut.com/uae_dubai_apartments/burj_khalifa__burj_dubai__nice_2_b_r_apartment_for_sale-470163.html



Information About Burj Khalifa (Burj Dubai):



The goal of Burj Dubai is not simply to be the world's highest building. It's to embody the world's highest aspirations. Burj Dubai looks different depending on where you're standing. For those living nearby. It is a shining accomplishment – tangible proof of Dubai's central role in a growing world. For those standing in other global capitals, it is a shining symbol – an icon of the new Middle East: prosperous, dynamic, and successful. In fact, Burj Dubai is both. It is a fact – an unprecedented example of international cooperation – and a symbol – a beacon of progress for the entire world. It is not by chance that it is being built in Dubai. In less than thirty years, this city has transformed itself from a regional center to a global one. This success was not based on oil reserves, but on reserves of human talent, ingenuity and initiative. A vision this bold requires visionaries.

Creating the centerpiece for a new world capital attracted the world's most esteemed designers, developers and builders. One of them is the tower's architect, Adrian Smith. Burj Dubai reflects not only the unique desert light, but the unique culture and environment of Dubai. In every part of the world, the most enduring buildings are those that learn from the surrounding culture, geography and natural history. NO stranger to Middle Eastern design, Adrian Smith incorporated patterns from traditional Islamic architecture into Burj Dubai. But above all, he drew inspiration from a flower. The Hymenocallis is a plant that is widely cultivated in Dubai, In India and throughout this region. The flower's harmonious structure is one of the organizing principles in the tower's design.

After designers. One of the pleasures of life at Burj Dubai is constantly discovering new examples of this guiding philosophy. It is a simple principle, but one that is extremely difficult to achieve: to set a new world standard for quality. It requires attention to every detail-both the ones that people encounter daily and the ones few will ever see. It means using the world's finest concrete and steel to quietly support the world's most luxurious surfaces. It means finding the right structural engineers to maximize window area, and ten the top designers who will do magic with the extra light. Exclusive Corporate Suite Offices, Residential Suites, Four Luxurious Pools, A

Cigar Club, Observation Platform, Restaurants, Library, Exclusive Resident's Lounge, 15,000 square feet for fitness.</div>

➤ **Burj Khalifa (Burj Dubai) Image Gallery:**



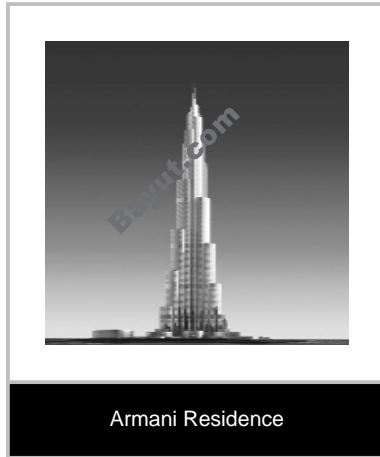

For larger view click link below

http://www.bayut.com/uae_dubai_apartments/burj_khalifa__burj_dubai__nice_2_b_r_apartment_for_sale-470163.html