

Bayut.com

For all your property needs

B
a
y
u
t
.c
o
m



Table of Contents

Property Description	3
Contact Details	3
Property Features.....	4
Image Gallery	5
Floorplans.....	6
Development	7

Property Description:



2 Beds Apartments

Excellent two bedrooms apartment is available for sale. It is located on 30th floor of Marina Scape Oceanic, Dubai Marina, Dubai with amazing Marina, sea and Palm views. Feel free to contact us for further details.

- **Type** Apartment
- **Status** Expired
- **Bedrooms** 2
- **Price** 2,650,000 AED
- **Area** 2,173 Sq. Ft.
- **Location** UAE » Dubai » Dubai Marina » Marina Scape Oceanic

Contact Details:

- **Name** Maryam
- **Phone**
- **Fax**
- **Cell**
- **Address**

Property Features:

Main Features

- 24 Hours Concierge
- Balcony or Terrace
- Central Air-Con
- Central Heating
- Completion Year 2007
- Double Glazed Windows
- Electricity Backup
- Elevators in Building 3
- Floors in Building 34
- Lobby in Building
- Other Main Features Reserved car parks for each unit, camera covered parking/public area, rich lift corridors, 15 inch color touch screen control panel, remote push button lighting control, remote home temperature control, remote area home surveillance, SMS fire burglar alert, virtual parenting via 3 G super wired modules, squash courts, Infinity swimming pool and temperature controlled indoor pool. private room top swimming pool for the penthouses, aerobics and yoga alcoves, exclusive snooker/billiard room, banquet Hall, Sky Lawn facilities with each penthouse, exclusive Hanging gardens, yacht club, Aqua sports facilities.
- Parking Spaces
- View maina, sea, palm
- Waste Disposal

Rooms

- Laundry Room

Business and Communication

- Broadband Internet
- Intercom
- Satellite/Cable TV

Healthcare and Recreation Facilities

- Jacuzzi
- Kids Play Area
- Sauna
- Steam Room
- Swimming Pool

Healthcare and Recreation Facilities in Building

- Barbeque Area
- First Aid Medical Center
- Gym or Health Club
- Sauna
- Swimming Pool

► Image Gallery:

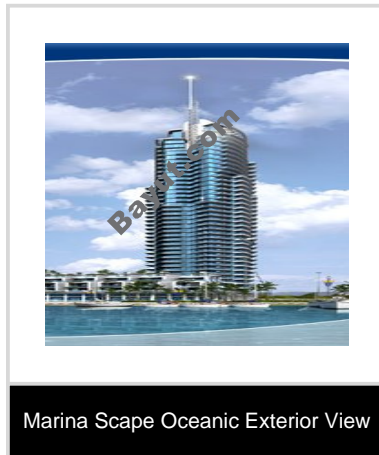

For larger view click link below

http://www.bayut.com/uae_dubai_apartments/marina_scape_oceanic_2_bedroom_apartment_for_sale-459487.html

Floorplans:

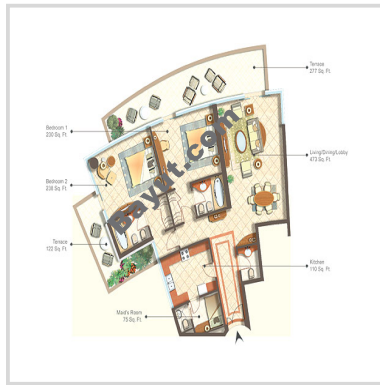

Condominium Type 0-4_2 Bedroom

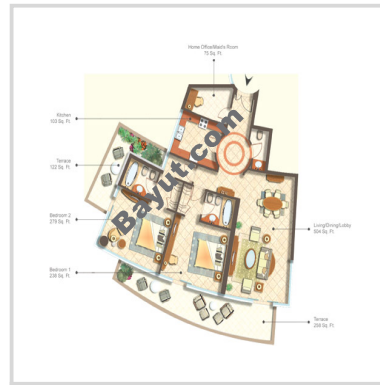

Condominium Type 0-3_2 Bedroom

For larger view click link below

http://www.bayut.com/uae_dubai_apartments/marina_scape_oceanic_2_bedroom_apartment_for_sale-459487.html

Information About Marina Scape Oceanic:



The marinascape is the epitome of luxury living conceived through inspired design and advanced technology. It occupies the premier site directly alongside the waterfront with unrivalled aspects toward the mouth of the Marina. The MarinaScape comprises of two fabulous residential towers- the Avant Tower and the Oceanic Tower; stunning waterfront villas-the Marina Homes and a fully equipped health and leisure centre-the Aqua Centro, to complete what will become the defining feature of Marina landscape. The Oceanic Tower is the taller of the two towers at the MarinaScape. This 34-storey-high tower consists of two and three bedroom condominiums and 2 three-storey penthouses. Its sleek lines and cutting edge design resonates with modern nautical references.

The Avant Tower, 26-storey-tall, comprises of 80 two and three bedroom luxury condominiums and two penthouses. The residences interiors are all extensively proportioned to provide beautiful living spaces and incomparable amenities. The Marina Homes are elegant waterfront villas with incredible views. Designed over four floors with expansive terraces, each of the Marina Homes has its own exotic "hanging garden", a separate floor dedicated to the master suite and a private lift. The Aqua Centro is a state-of-the-art health and fitness centre. Equipped with temperature controlled indoor pool, multiple saunas, Jacuzzis, squash courts, yoga alcove, banquet hall and a yacht club, the Aqua Centro provides outstanding recreational mix.

24 hour maintenance, reserved car parks for each unit, three high speed elevators, broadband super connectivity for all units, fully equipped laundry room for heavy duty washing, closed circuit television, camera covered parking/public area, exclusively designed lobby, rich lift corridors, 15 inch color touch screen control panel, remote push button lighting control, remote home temperature control, remote area home surveillance, sms fire burglar alert, virtual parenting via 3 g super wired modules, bbq area, squash courts, two fully equipped gymnasiums indoor and over looking the marina waters, infinity swimming pool and temperature controlled indoor pool, private room top swimming pool for the penthouses, aerobics and yoga alcoves, exclusive snooker/billiard room, banquet hall, children's play area, sky lawn facilities with each penthouse, exclusive

hanging gardens, yacht club, aqua sports facilities.</div>

➤ Marina Scape Oceanic Image Gallery:

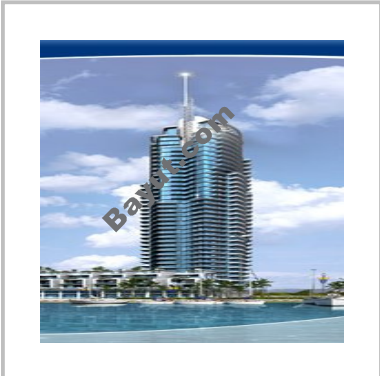

Marina Scape Oceanic Exterior View



Marina Scape Oceanic Swimming Pool

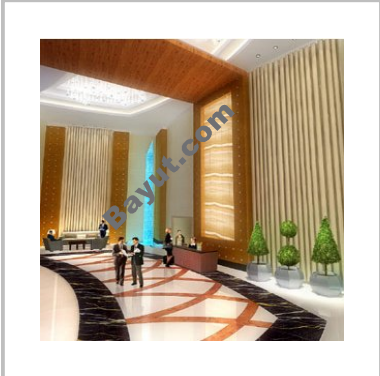

Marina Scape Oceanic Entrance Lobby

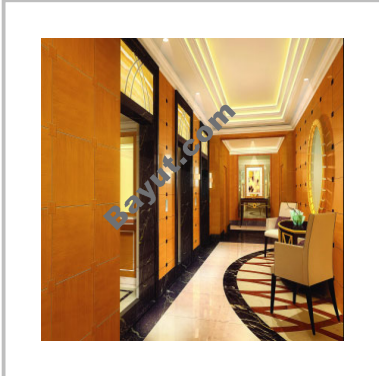

Marina Scape Oceanic Interior View 1



Marina Scape Oceanic Interior View 2



Marina Scape Oceanic Meeting Room

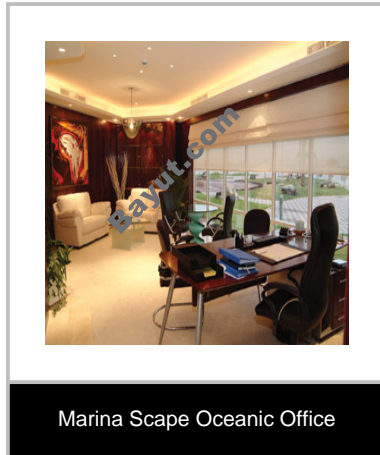

For larger view click link below

http://www.bayut.com/uae_dubai_apartments/marina_scape_oceanic_2_bedroom_apartment_for_sale-459487.html