

Bayut.com

For all your property needs

B
a
y
u
t
.c
o
m



Table of Contents

Property Description	3
Contact Details	3
Property Features.....	4
Image Gallery	5
Floorplans.....	6
Development	7

Property Description:



559 Sq. Ft. Shops

Spacious shop is available for sale located in China Cluster, International City having 559 square feet. Selling below original price. For more details feel free to contact us.

- **Type** Shop
- **Status** Property Unavailable
- **Bedrooms** 0
- **Price** 300,000 AED
- **Area** 559 Sq. Ft.
- **Location** UAE » Dubai » International City » China

Contact Details:

- **Name** Alex
- **Phone** +971 4 2942956 / 57
- **Fax** +971 4 2942955
- **Cell**
- **Address**

Property Features:

Main Features

- 24 Hours Concierge
- Central Air-Con
- Completion Year 2007
- Lobby in Building
- Other Main Features Post office, police station, transportation services.
- Parking Spaces
- Waste Disposal

Business and Communication

- Broadband Internet
- Intercom
- Satellite/Cable TV

Healthcare and Recreation Facilities

- Jacuzzi
- Sauna
- Steam Room
- Swimming Pool

Healthcare and Recreation Facilities in Building

- First Aid Medical Center
- Gym or Health Club

Nearby Locations

- Nearby Schools three schools

Other Facilities

- Cafeteria or Canteen
- Other Facilities Huge parking area, several entertainment facilities and outdoor theatres. restaurants, 5,000 shops, top class hotels and exhibition centers.

Image Gallery:

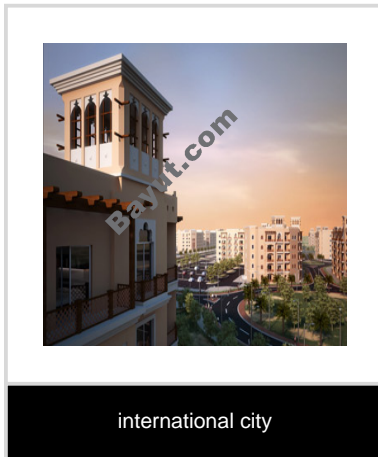

For larger view click link below
http://www.bayut.com/uae_dubai_shops/china_shop_for_sale-454600.html

► Floorplans:

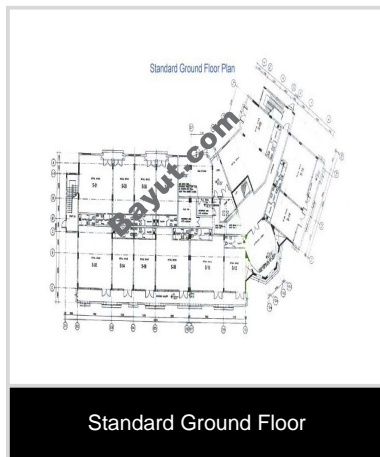

For larger view click link below

http://www.bayut.com/uae_dubai_shops/china_shop_for_sale-454600.html



Information About China:



<div align="justify">Land of the Great Wall, the Forbidden City, the Terracotta warriors, the Yangzi River, colonial Shanghai, the imperial grandeur of Beijing and Tiananmen Square, China isn't just a country - it's a different world. With sacred mountains, shopping havens, national parks, exceptional teas, iconic skyscrapers and an unquenchable thirst for progress, the yin of its imperial past is balanced by the yang of 21st Century economic growth. International City's 'China' lies at one end of the residential district, near the DragonMart Complex. The simple lines of these two, three and four storey buildings reflect a sense of harmony and balance. Traditional Chinese motifs, balconies, red tile overhangs and pagodas dominate the facades while the undulating style of the roofs suggests a sense of the dragon. The neighborhood of China is widespread, touching Morocco and England in International City 300 acre residential district. The neighborhood is just 4-minute walk away from the outer limits of International City, located on the Emirates Road. It is close to Dubailand and the Dubai International Airport.</div>



China Image Gallery:



China Cluster



international city

For larger view click link below

http://www.bayut.com/uae_dubai_shops/china_shop_for_sale-454600.html