

# Bayut.com

For all your property needs

B  
a  
y  
u  
t  
.c  
o  
m



## Table of Contents

Property Description .....	3
Contact Details .....	3
Property Features.....	4
Image Gallery .....	5
Development .....	6

## Property Description:



### 1 Bed Apartments

STR NO: 683/3676/09/12/0044, Apartment For Sale in Iris Amber, Culture Village, 2nd floor, 1 bedroom, Type 4, 1280 sqft, 20% paid, Rest of the payment plan attached, Original Price: 2,117,120 AED, Agency Fee (Buyer): 40,340 AED, Transfer Fee (Buyer): 5,000 AED.

- **Type** Apartment
- **Status** Property Unavailable
- **Bedrooms** 1
- **Price** 2,017,000 AED
- **Area** 1,280 Sq. Ft.
- **Location** UAE » Dubai » Culture Village » Iris Amber

## Contact Details:

- **Name** Mohammed Yasin
- **Phone** +971 4 3967227
- **Fax**
- **Cell**
- **Address**

## Property Features:

### Main Features

- 24 Hours Concierge
- Balcony or Terrace
- Central Air-Con
- Completion Year 2009
- Floors in Building 9
- Lobby in Building
- Parking Spaces
- Waste Disposal

### Business and Communication

- Broadband Internet
- Intercom
- Satellite/Cable TV

### Healthcare and Recreation Facilities

- Lawn or Garden
- Swimming Pool

Image Gallery:

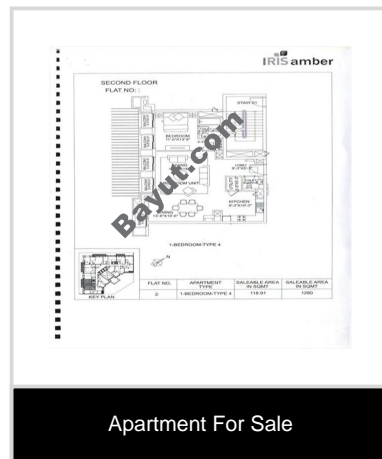
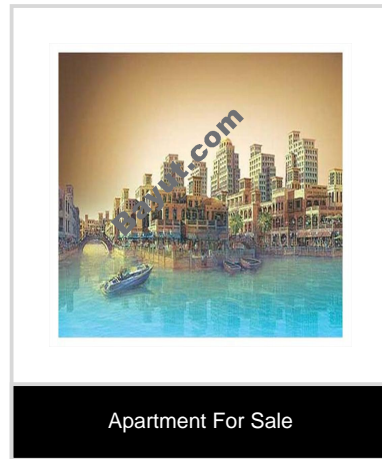
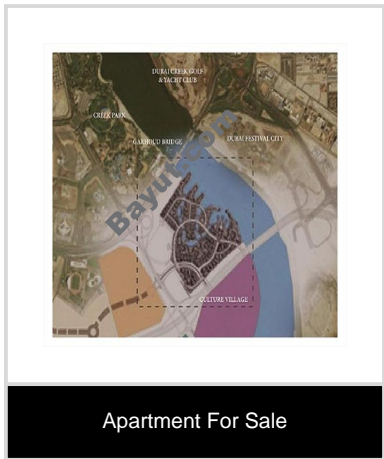
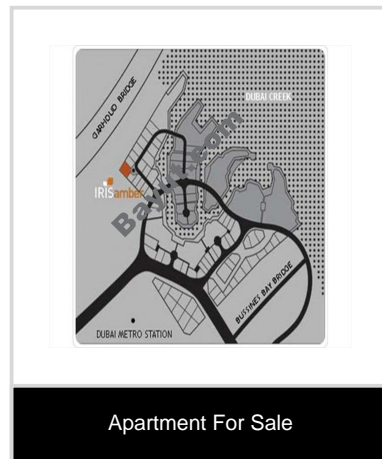
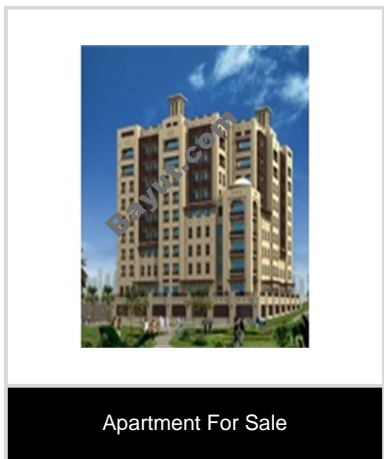

For larger view click link below  
[http://www.bayut.com/uae\\_dubai\\_apartments/iris\\_amber\\_apartment\\_for\\_sale-425845.html](http://www.bayut.com/uae_dubai_apartments/iris_amber_apartment_for_sale-425845.html)

## Information About Iris Amber:



Another vision from Iris, and another piece of brilliant design from master architects Atkins, Iris Amber will bear out all the rich associations with artistry, culture, colour and light that its name suggests. Arabesque style and quality will make it the architectural equivalent of a well crafted item of Arabian jewellery, or a finely cut piece of amber. Traditional Arabesque details including wind towers & domes, Private balconies and outdoor living spaces, Fragrant Arabian style gardens, Rooftop swimming pools, Spacious studio, one and two bedroom apartment layouts, Convenient access to the Garhoud and Business Bay bridges, Close proximity to the future Dubai Metro line. Iris Amber will be a picture of inspiration, with environs which only enhance its value. And with the building's artful array of studio, one and two bedrooms apartments, Iris Amber will appeal to the young and socially engaged denizens of Culture Village.

Iris Amber will be strategically positioned with a frontage on the wide open spaces, cobblestone walkways and abundant aesthetic advantages of Culture Village. Meanwhile, its west facing exterior will offer sweeping prospects of the area due to be set behind it: fresh parkland fringing Dubai Creek over which the Arabian sun will drop. Iris Amber's Arabesque style and quality will make it the architectural equivalent of a finely cut piece of amber. Wind towers will grace the building's traditional medium rise elevation, and decorative latticed balconies, in keeping with their historical purpose, will provide privacy and refreshing breezes as well as splendid vistas. Spacious studio, one, and two bedroom apartment layouts, Private balconies and outdoor living spaces, Traditional flourishes and details, Podium car parking, Workout facilities. Iris Amber's mousharabieh, its traditional Arabic awnings and balconies, will be sandalwood in colouring, while its walls will have the golden shade of the desert sand.

Iris Amber will be positioned to gain the maximum in satisfying exposure to the sunshine, and as it catches the sun's rays will glow gem-like with deep oranges, browns, and yellows – the sun-filled tones evoked by its name. Just as amber has the meaning of a pleasant aroma in Arabic, so Iris Amber will be a building for the senses. Traditional Arabesque details, including crenneled parapets & domes,

Private balconies and outdoor living spaces, Fragrant Arabian style gardens, Rooftop swimming pools, Nine storey elevation. With an angled architectural design which effectively creates its own forecourt at the apex of Culture Village's residential quarter, Iris Amber's façade will have the aspect of an open scroll, or a screen one might find in an artist's studio. IRIS Amber will be ideally located in Culture Village, along the banks of the Creek. With quick and convenient access to the Garhoud and Business Bay bridges, Sheikh Zayed Road, and a short walk from the Dubai Metro, IRIS Amber will prove a welcome haven in the midst of the heart of Dubai.</div>



## Iris Amber Image Gallery:



Iris Amber Exterior View 1



Iris Amber Exterior View 2



Iris Amber Exterior View 3

For larger view click link below

[http://www.bayut.com/uae\\_dubai\\_apartments/iris\\_amber\\_apartment\\_for\\_sale-425845.html](http://www.bayut.com/uae_dubai_apartments/iris_amber_apartment_for_sale-425845.html)