

Bayut.com

For all your property needs

B
a
y
u
t
.c
o
m



Table of Contents

Property Description	3
Contact Details	3
Property Features.....	4
Image Gallery	5
Development	6

Property Description:



11,096 Sq. Ft. Floors

11096 square feet, full residential floor is available for sale. It is located in Worldwide Tower, Downtown Jebel Ali. Contact us for further details.

- **Type** Residential Floor
- **Status** Expired
- **Bedrooms** 0
- **Price** 18,863,608 AED
- **Area** 11,096 Sq. Ft.
- **Location** UAE » Dubai » Downtown Jebel Ali » Worldwide Tower

Contact Details:

- **Name** STS International Properties
- **Phone** +971 4 3525336
- **Fax** +971 4 3525337
- **Cell**
- **Address**

Property Features:

Main Features

- Central Air-Con
- Land Area 11096
- Waste Disposal

Business and Communication

- Broadband Internet

Healthcare and Recreation Facilities

- Lawn or Garden
- Swimming Pool

Other Facilities

- Security Staff

► Image Gallery:



Worldwide Tower

For larger view click link below

http://www.bayut.com/uae_dubai_floors/worldwide_tower_full_residential_floor_for_sale-361399.html

Information About Worldwide Tower:

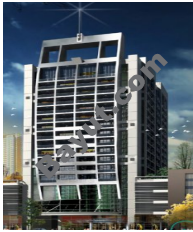

A home that will open through a whole new concept in lifestyle. There's so much in store for you here in Worldwide Tower. Offering a home that is so self contained with tranquil surrounding and with enough activities for adults and children. The product offers amenities. Such as health spa. Ultra modern gym, free flowing outdoor swimming pool, steam and sauna. So if you have always believed in high quality living. It is time to put your beliefs into action. It is a great place for your family and a smart investment for tomorrow. Jebel Ali Downtown is located is located at the heart of Dubai's largest new employment and commercial area. Set along Sheikh Zayed road and between JAFZA. The port of Dubai, and Tecnology Park, it will become the circulation hub of the western end of the city.

The strategic location means that housing office retail and entertainment development on site will fill a growing need in a timely manner. Easy access to the port, airport, industrial zones and the golf means that the mixed use communities of Jebel Ali will be a desirable place to live, work and shop. It is destined to become the urban center of a diverse and fast growing new city. A home that will open through a whole new concept in lifestyle. There's so much in store for you here in Worldwide Tower. Offering a home that is so self contained with tranquil surrounding and with enough activities for adults and children. The product offers amenities. Such as health spa. Ultra modern gym, free flowing outdoor swimming pool, steam and sauna. So if you have always believed in high quality living. It is time to put your beliefs into action. It is a great place for your family and a smart investment for tomorrow.

As lavish as those common amenities are, the sleek interiors of WORLDWIDE that will likely make or break the deal for home buyers looking for an elegant contemporary nest. Cloaked in the clean, traditional aesthetic architecture, every apartment bears testimony to the unprecedented quality and luxury that you enjoy at WORLDWIDE. Worldwide is loaded with all the added benefits and services to make life easy and merry. Dive into the cool blue waters of the swimming pool, or stays fit at the health club, or just relax and soothe your senses by taking a steam, sauna or Jacuzzi and experience pur pampering and relaxation. While you're busy enjoying all the facilities, the

kids can have fun in the kids zone full of games and activities.



Worldwide Tower Image Gallery:

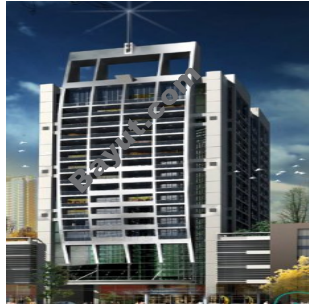

Worldwide Tower

For larger view click link below

http://www.bayut.com/uae_dubai_floors/worldwide_tower_full_residential_floor_for_sale-361399.html